



MASON INDUSTRIES, Inc.

Manufacturers of Vibration Control Products

350 Rabro Drive Hauppauge, NY 11788
 631/348-0282
 FAX 631/348-0279
 Info@Mason-Ind.com
 www.Mason-Ind.com

2101 W. Crescent Ave., Suite D
 Anaheim, CA 92801
 714/535-2727
 FAX 714/535-5738
 Info@MasonAnaheim.com

JOB NAME _____
 CUSTOMER _____
 CUSTOMER P.O. _____
 MASON M.I. _____
 DWG. NO. _____

SAB

Certified Seismic
 Anchor Bolt
 with Washer

ALL PARTS
 ELECTROPLATED

"CS" CAP SCREW
 WITH STANDARD
 WASHER

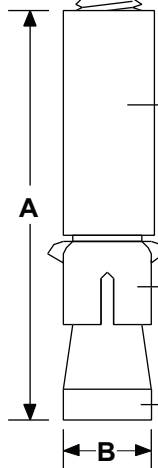

SEISMIC ANCHOR
 (Internally Threaded)

EXPANSION
 WEDGE

PULL THROUGH
 RESISTANT
 SHOULDER

TYPE SAB ANCHOR BOLT RATINGS installed into 3000 psi (20 Mpa) concrete

| Size | Minimum Anchor Embedment (in) (mm) | Minimum Edge Distance (in) (mm) | Minimum Anchor Spacing (in) (mm) | Concrete Type | | | | | | | |
|---------|------------------------------------|---------------------------------|----------------------------------|---------------------|------------------|---------------------|------------------|---------------------|------------------|---------------------|------------------|
| | | | | Stone Aggregate | | | | Lightweight | | | |
| | | | | Tension* (lbs)(kg)† | Shear (lbs)(kg)† | Tension* (lbs)(kg)† | Shear (lbs)(kg)† | Tension* (lbs)(kg)† | Shear (lbs)(kg)† | Tension* (lbs)(kg)† | Shear (lbs)(kg)† |
| SAB-3/8 | 2 5/8 67 | 5 1/4 133 | 7 7/8 200 | 720 327 | 1050 476 | 575 261 | 840 382 | — | — | — | — |
| SAB-1/2 | 3 1/2 89 | 7 178 | 10 1/2 267 | 1010 458 | 1830 830 | 800 363 | 1500 680 | — | — | — | — |
| SAB-5/8 | 4 3/8 111 | 8 3/4 222 | 13 1/8 333 | 2220 1007 | 2970 1347 | 1625 737 | 2720 1234 | — | — | — | — |
| SAB-3/4 | 5 1/4 133 | 10 1/2 267 | 15 3/4 400 | 2330 1057 | 3340 1515 | — | — | — | — | — | — |
| SAB-1 | 5 3/4 146 | 11 1/2 292 | 17 1/4 438 | 3660 1524 | 6610 2998 | — | — | — | — | — | — |

*These tension values are applicable when the anchors are installed without special inspection as set forth in Section 1701.1 of UBC. When anchors are installed with special inspection as set forth in Section 1701.1 of the UBC, the tabulated values may be increased by 100%.

† For kN divide kg by 102

Notes:

The tabulated values are for anchors installed at the specified spacings and edge distance. Spacings may be reduced by 67% provided the tension values are reduced to 50% (65% for SAB-1) and the shear values are reduced by 60%. Edge distances may be reduced by 50% provided the tension values are reduced by 30% and the shear values are reduced by 50%. Linear interpolation may be used for intermediate spacings.

For combined tension and shear forces on anchors, use the following equations:

$$(P_s/P_t)^{5/3} + (V_s/V_t)^{5/3} \leq 1.0$$

where: P_s and V_s are Applied Forces
 and P_t and V_t are Allowable Forces

Ratings may be increased 33 1/3 % to accommodate periodic forces such as wind or seismic loads. Tabulated values include a safety factor of 8 to 1 for tension forces and 4 to 1 for shear forces.

For Stone Aggregate Concrete, refer to ICBO Report #ER-5063.
 For Lightweight Concrete, refer to Techmar report #TR-1193.

TYPE SAB ANCHOR BOLT DIMENSIONS

| Size | A | | B | | CS | |
|---------|---------|------|-------|------|---------------------|------------------|
| | (in) | (mm) | (in) | (mm) | (in) | (mm) |
| SAB-3/8 | 2 5/16 | 67 | 1/2 | 13 | 3/8"-16 UNC x 1 1/4 | 3/8"-16 UNC x 32 |
| SAB-1/2 | 3 1/16 | 89 | 5/8 | 16 | 1/2"-13 UNC x 1 1/2 | 1/2"-13 UNC x 38 |
| SAB-5/8 | 3 13/16 | 111 | 7/8 | 22 | 5/8"-11 UNC x 1 3/4 | 5/8"-11 UNC x 44 |
| SAB-3/4 | 4 5/8 | 133 | 1 | 25 | 3/4"-10 UNC x 2 1/4 | 3/4"-10 UNC x 57 |
| SAB-1 | 5 | 146 | 1 1/4 | 32 | 1"- 8 UNC x 2 1/2 | 1"- 8 UNC x 64 |

CERTIFICATION DATA

| TYPE | QTY. | TAG |
|------|------|-----|
| | | |
| | | |
| | | |
| | | |
| | | |
| | | |
| | | |
| | | |
| | | |
| | | |