



**MERCER
RUBBER Co.**

350 Rabro Drive
Hauppauge, NY 11788
Tel 631-582-1524
FAX 631-348-0279
Info@Mercer-Rubber.com
www.Mercer-Rubber.com

**SLEEVE TYPE
EXPANSION
JOINTS**

Series
300 & 310

BULLETIN 300-MR4

**1 ARCH
STYLE 301 AND 311 EXPANSION JOINTS**

300- Standard Pressure, Low Vacuum
310- High Pressure, High Vacuum

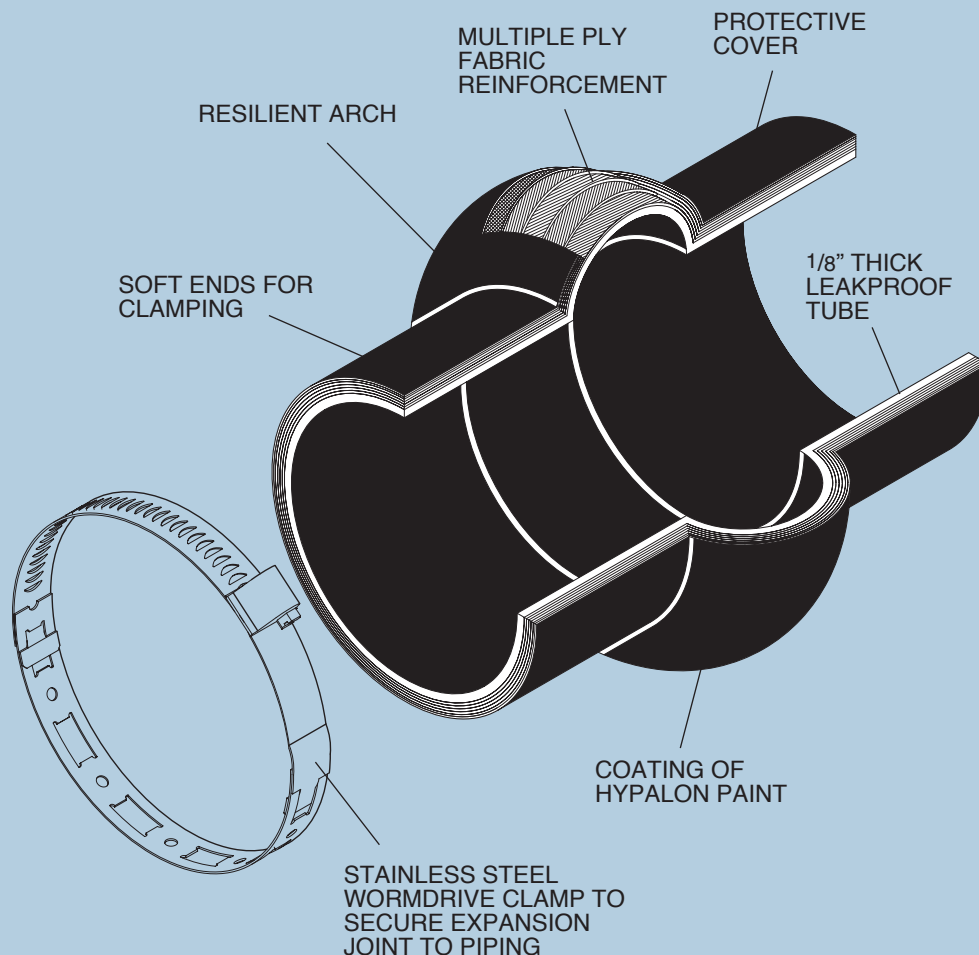

Series 300 & 310			
Material Availability & Operating Temperatures			
Series	STANDARD MATERIALS		Max Oper. Temp.
300	Tube	Cover	
310			
B	Butyl	Butyl	250°F
E	EPDM	EPDM	250°F
H	Hypalon	Hypalon	225°F
HN	Hypalon	Neoprene	225°F
N	Neoprene	Neoprene	225°F
NH	Neoprene	Hypalon	225°F
Ni	Nitrile	Nitrile	210°F
NiN	Nitrile	Neoprene	210°F
NR	Neoprene	Natural	225°F
R	Natural	Natural	180°F
RN	Natural	Neoprene	180°F
V	Viton®	Viton®	250°F

Food Grade Rubber Available.
See back page for Dimensions, Allowable Movements and Pressures.

IMPORTANT: Since sleeve type expansion joints cannot be readily protected with control rods, it is **IMPERATIVE** that piping be axially aligned, properly guided and **PROPERLY ANCHORED**.

Periodic tightening of clamps may be necessary.

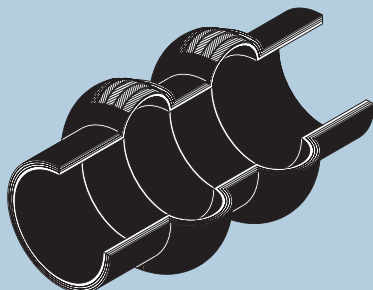

**2 Arch
Style 302 & 312**

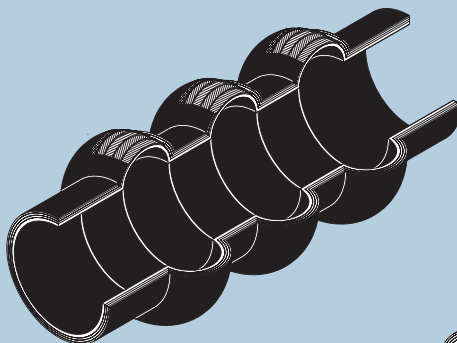

**3 Arch
Style 303 & 313**

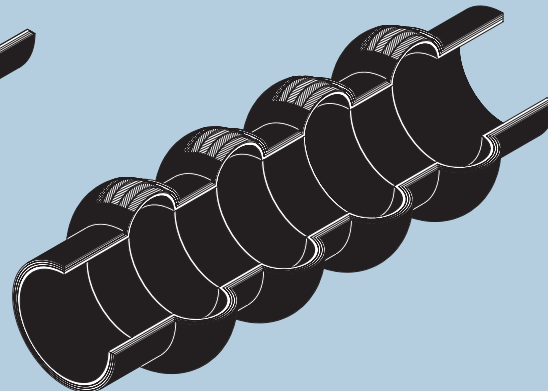

**4 Arch
Style 304 & 314**

1 Arch
Style 301 & 311

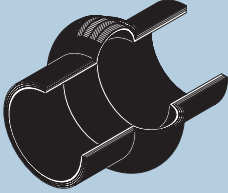

2 Arch
Style 302 & 312

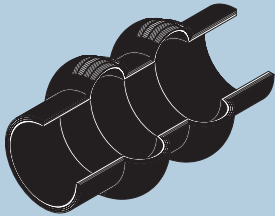

3 Arch
Style 303 & 313

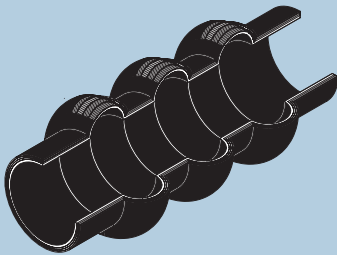

4 Arch
Style 304 & 314

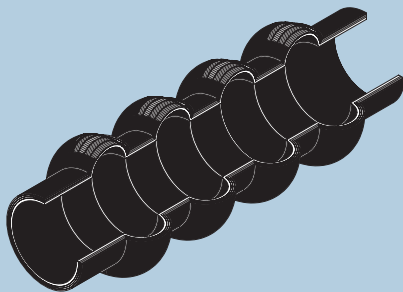

Mercer Size*	Face To Face (in)	Allowable Movements			Rated Working Pressure (psi)		Vacuum Rating (in Hg.)	
		Axial Compression (in)	Axial Extension (in)	Lateral Deflection (in)	301-304	311-314	301-304	311-314
STYLE 301 & 311 DIMENSIONS, ALLOWABLE MOVEMENTS AND OPERATING PRESSURES								
1 1/2	6	13/4	7/8	1	90	140	15	30
2	6	13/4	7/8	1	90	140	15	30
2 1/2	6	13/4	7/8	1	90	140	15	30
3	6	13/4	7/8	1	90	140	15	30
4	6	13/4	7/8	1	90	140	15	30
5	6	13/4	7/8	1	50	125	15	30
6	6	13/4	7/8	1	50	125	15	30
8	6	13/4	7/8	1	25	125	15	30
10	6	13/4	7/8	1	25	125	15	30
12	6	13/4	7/8	1	25	125	15	30
14	8	2 1/8	1	1 1/4	20	90	15	30
16	8	2 1/8	1	1 1/4	20	90	15	30
18	8	2 1/8	1	1 1/4	15	90	15	30
20	8	2 1/8	1	1 1/4	15	70	15	30
22	10	2 5/8	1 1/4	1 1/2	15	70	15	30
24	10	2 5/8	1 1/4	1 1/2	15	70	15	30
STYLE 302 & 312 DIMENSIONS, ALLOWABLE MOVEMENTS AND OPERATING PRESSURES								
1 1/2	10	3 1/2	1 3/4	2	50	105	15	30
2	10	3 1/2	1 3/4	2	50	105	15	30
2 1/2	10	3 1/2	1 3/4	2	50	105	15	30
3	10	3 1/2	1 3/4	2	50	105	15	30
4	10	3 1/2	1 3/4	2	50	105	15	30
5	10	3 1/2	1 3/4	2	35	90	15	30
6	10	3 1/2	1 3/4	2	35	90	15	30
8	10	3 1/2	1 3/4	2	20	90	15	30
10	10	3 1/2	1 3/4	2	20	90	10	30
12	10	3 1/2	1 3/4	2	20	90	10	30
14	12	4 1/4	2	2 1/2	15	70	10	30
16	12	4 1/4	2	2 1/2	15	70	5	30
18	12	4 1/4	2	2 1/2	10	70	5	30
20	12	4 1/4	2	2 1/2	10	55	5	30
22	14	5 1/4	2 1/2	3	10	55	5	30
24	14	5 1/4	2 1/2	3	10	55	5	30
STYLE 303 & 313 DIMENSIONS, ALLOWABLE MOVEMENTS AND OPERATING PRESSURES								
1 1/2	14	5 1/4	2 5/8	3	25	75	10	30
2	14	5 1/4	2 5/8	3	25	75	10	30
2 1/2	14	5 1/4	2 5/8	3	25	75	10	30
3	14	5 1/4	2 5/8	3	25	75	10	30
4	14	5 1/4	2 5/8	3	25	75	10	30
5	14	5 1/4	2 5/8	3	25	65	10	30
6	14	5 1/4	2 5/8	3	25	65	10	30
8	14	5 1/4	2 5/8	3	25	65	10	30
10	14	5 1/4	2 5/8	3	25	65	5	30
12	14	5 1/4	2 5/8	3	25	65	5	30
14	16	6 3/8	3	3 3/4	10	50	5	30
16	16	6 3/8	3	3 3/4	10	50	5	30
18	16	6 3/8	3	3 3/4	10	50	5	30
20	16	6 3/8	3	3 3/4	10	40	5	30
22	18	7 7/8	3 3/4	4 1/2	10	40	5	30
24	18	7 7/8	3 3/4	4 1/2	10	40	5	30
STYLE 304 & 314 DIMENSIONS, ALLOWABLE MOVEMENTS AND OPERATING PRESSURES								
1 1/2	18	7	3 1/2	4	15	55	10	30
2	18	7	3 1/2	4	15	55	10	30
2 1/2	18	7	3 1/2	4	15	55	10	30
3	18	7	3 1/2	4	15	55	10	30
4	18	7	3 1/2	4	15	55	10	30
5	18	7	3 1/2	4	15	40	10	30
6	18	7	3 1/2	4	15	40	10	30
8	18	7	3 1/2	4	15	40	10	30
10	18	7	3 1/2	4	15	40	5	30
12	18	7	3 1/2	4	15	40	5	30
14	20	8 1/2	4	5	5	30	5	30
16	20	8 1/2	4	5	5	30	5	30
18	20	8 1/2	4	5	5	30	5	30
20	20	8 1/2	4	5	5	30	5	30
22	22	10 1/2	5	6	5	30	5	30
24	22	10 1/2	5	6	5	30	5	30

*Fits over nominal pipe sizes and tubing listed

